

A-ALT07 single point load cell

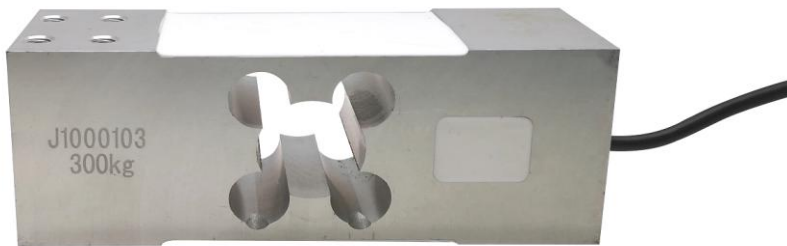

Description

A-ALT07 is strain gauge based load cell constructed from aluminum alloy for high accuracy. It is hermetically sealed with glue to IP65, surface anodized and anti-corrosion, integral structure and easy installation.

Application

- Electronic scale
- Floor scale
- Compression testing device
- Other weighing equipment

Main Dimensions and Accessories(mm)

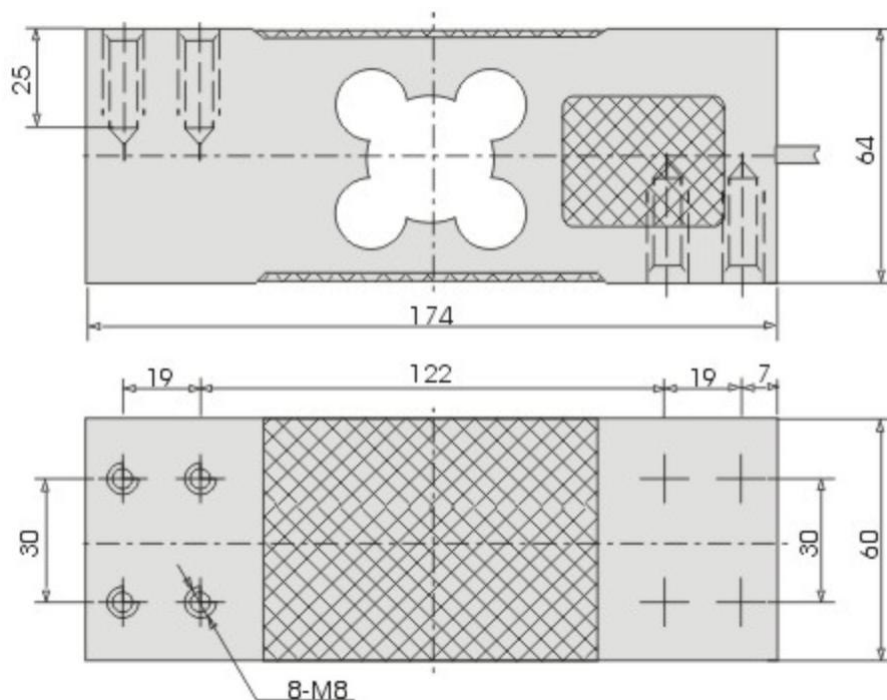

Specifications

Capacity	50~1000kg	Zero balance	±2%F.S
Rated output	2.0mV/V±0.1%	Input resistance	405±10Ω
Accuracy class	C3,0.05	Output resistance	350±3Ω
Non-linearity	0.02, 0.05%F.S	Safe overload	120%F.S
Hysteresis	0.02, 0.05%F.S	Ultimate overload	150%F.S
Creep in 30 minutes	0.02, 0.05%F.S	Excitation voltage	9~12V DC
Temperature effect span	0.015%F.S/10°C	Insulation resistance	≥5000MΩ
Temperature effect zero	0.017%F.S/10°C	Environmental protection	IP65
Compensated temperature range	-10~+40°C		
Operating temperature range	-20~+60°C	Material	Aluminum

Cable: Φ5*3m

Wring: Green(EXC+), Black(EXC-), Green(SIG+), White(SIG-), Yellow(Shield)